

BA-1800 System



*Sold separately

BA-1800 is designed to disperse beneficial bacteria, nourishing your environment and supporting your indoor air quality, with a repetitive flow of Enviro-Biotics™.

Living and working in an environment rich with Enviro-Biotics™ enhances your well-being by cleaning your air, surfaces and objects, especially in those hard to reach areas.

IMPORTANT SAFETY INSTRUCTIONS

WARNING:

When using electric products, basic precautions should always be followed, including the following:

- Read all the instructions before using the product.
- To reduce the risk of injury, close supervision is necessary when a product is used near children.
- Do not put fingers or hands into the product.
- Do not repair or modify the unit.
- Do not alter the plug in any way. Do not use if the power cord or plug is damaged or the connection to the wall outlet is loose.
- Only use the cord provided by betterair
- Do not damage, break, forcefully bend, pull, twist, bundle, coat, pinch, or place heavy objects on the power cord.
- Remove the power plug from the outlet before cleaning the unit. When removing the power plug, grasp by holding the plug itself, never hold by the cord.
- Do not handle the power plug with wet hands.
- Clean the unit with dry fabric, do not use detergent to clean the unit.
- Do not use the unit on its side.
- KEEP OUT OF REACH OF CHILDREN.
- AVOID SWALLOWING AND EYE CONTACT.
- IF SWALLOWED - drink 1-2 glasses of water.
- IN CASE OF CONTACT WITH EYES - flush with water.

CAUTION: Do not place directly under lights or other heat sources over 100 degrees. Damage to the BA-1800 may occur.

- **CAUTION:** The appliance shall be mounted on the wall only. It is not intended to be used on surface such as the floor or a table.

SAVE THESE INSTRUCTIONS

Contact Us

contact@better-air.com



betterair

Quick Start Installation Guide

BA-1800

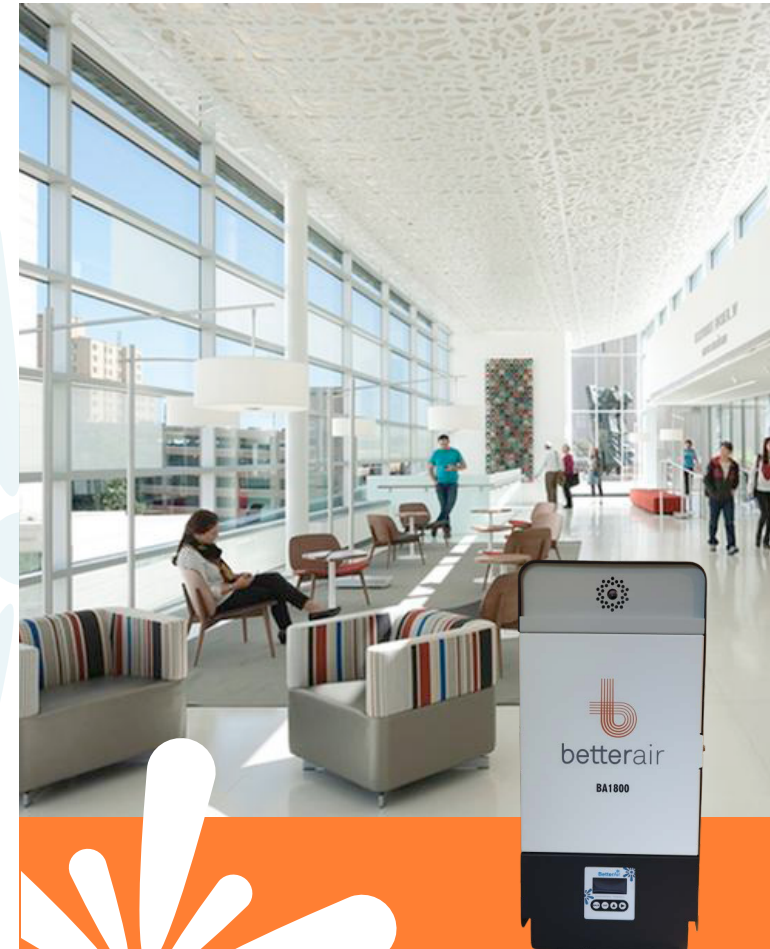

Pre Installation

Dispersion rate set up

Plug into power supply and press the ON button. Open the door using the provided keys.

Program 1

Refill will last approximately **1 months**.
The BA-1800 is pre-programmed for this dispersion rate.

Program 2

Refill will last approximately **2 months**.
To select Program 2, simply press the up arrow once.

Program 3

Refill will last approximately **3 month**.
To select Program 3, simply press the up arrow twice.



Time Set Up (optional)

- Press and hold the two arrow buttons on the right for 5 seconds.
- Use the up arrow to adjust hours / minutes.
- Use the right arrow to shift between hours and minutes.
- Press ENT to save.

Installation Instructions

Your BA-1800 should be located out of the reach of young children or pets. It is not advised to place the BA-1200 near an open door or a window that leads outdoor in order to obtain maximum coverage indoors.

HVAC Installation (up to 12,500sqf)

Step 1

Using the stickers and screws provided, mount the BA-1800 to the wall near the HVAC system and air duct supply. The wall must be capable of holding a weight up to 50lbs. Unit must be kept in upright position. Do not lay flat or place sideways.

Step 2

Drill a hole in the air supply duct above the air handler and insert the silver tube in the direction of the air flow. Make sure the blue hose is free from knots or obstructions for optimal airflow.

Secure and seal the metal plate to the air duct using HVAC tape.

wall constructions

As wall appliance mounted the product shall be mounted on the plywood board min. 0.5 in

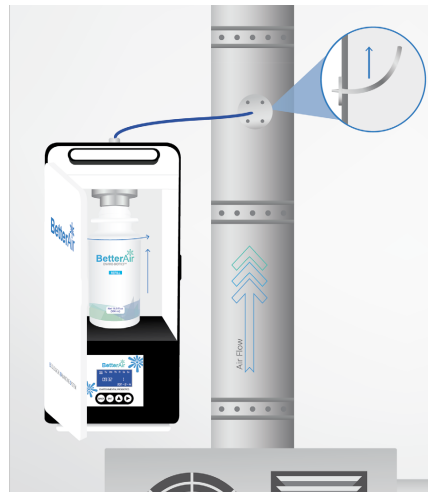

Free Stand Installation (up to 3,500sqf)

Before installing the unit, open the aerial dispersion railing, unscrew the bolt. Replace the railing.

Wall Mount installation for optimal performance: It is recommended to position the BA-1800 wall mount in proximity to an air flow. Drill two screws to fasten the wall mount on the wall. Make sure that there is an electric outlet in proximity to installation for the electric cord to reach.

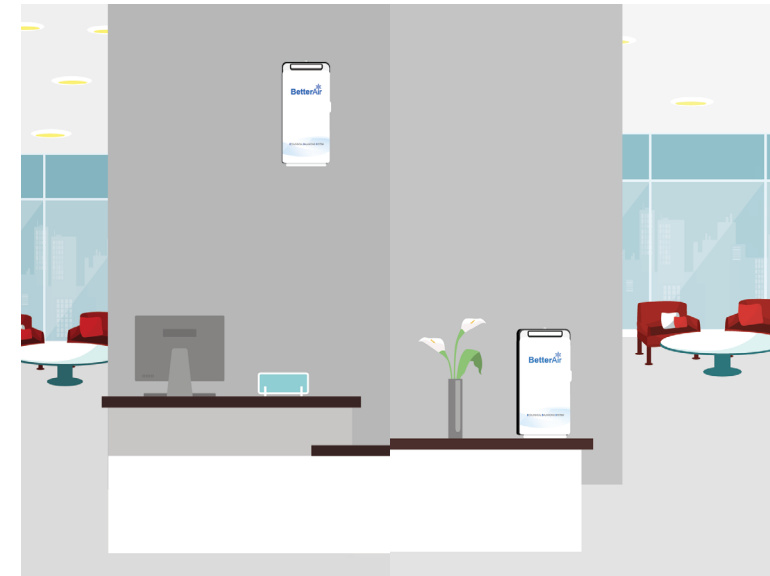

Refill installation

To insert the Enviro-Biotics™ refill bottle: Open the door of the BA-1800 unit. Shake and gently insert the bottle in the vertical position and rotate clockwise until secure. Plug in the BA-1800 to the power supply. Once plugged in, turn on the unit with the ON/OFF button.

